

STORM WATER MANAGEMENT POND

INDUSTRY LANE

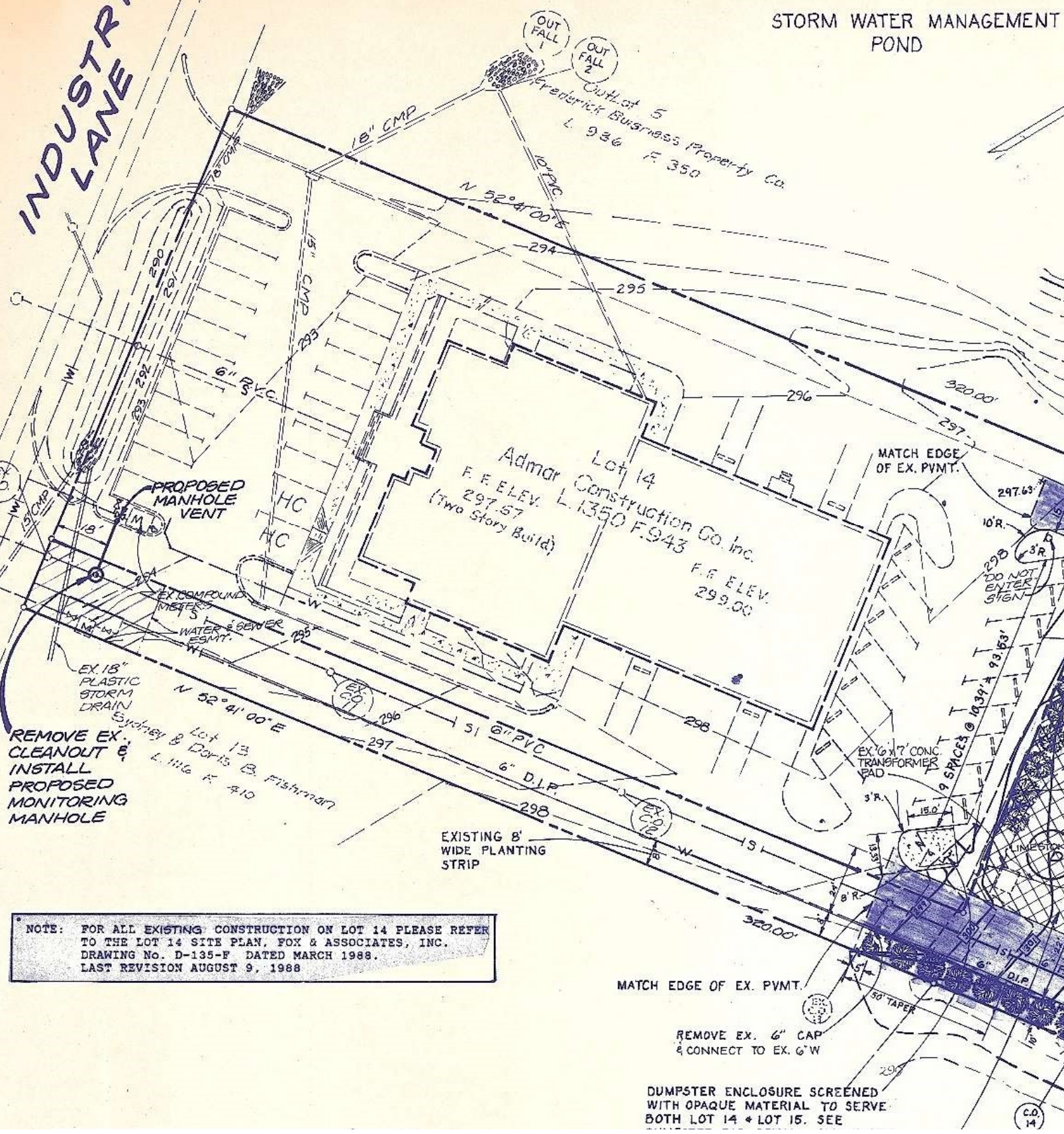

REMOVE EX. CLEANOUT & INSTALL PROPOSED MONITORING MANHOLE

Sydney & Doris B. Fishman  
L 1116 F. 410

NOTE: FOR ALL EXISTING CONSTRUCTION ON LOT 14 PLEASE REFER TO THE LOT 14 SITE PLAN, FOX & ASSOCIATES, INC. DRAWING No. D-135-F DATED MARCH 1988. LAST REVISION AUGUST 9, 1988

MATCH EDGE OF EX. PVMT.

REMOVE EX. 6" CAP & CONNECT TO EX. 6" W

DUMPSTER ENCLOSURE SCREENED WITH OPAQUE MATERIAL TO SERVE BOTH LOT 14 & LOT 15. SEE